

RAM 1010 profili za izradu staklenih frontova

RAM 1010 profil za front AL SM



| art. | j.m. | boja |
|--------------------------------|------|------------|
| 7140 | m | srebro mat |
| Prodajne dužine (m): 3,0 i 6,0 | | |

Ugaonici za sklapanje rama



| art. | j.m. | boja |
|------|------|-------|
| 9357 | kom | metal |

RAM 1010 profil za front AL CRNA

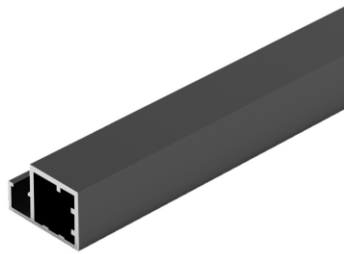

| art. | j.m. | boja |
|--------------------------------|------|----------|
| 9063 | m | crna mat |
| Prodajne dužine (m): 3,0 i 6,0 | | |

RAM PVC ispuna za staklo LIANA

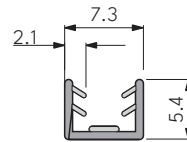

| art. | j.m. | boja |
|--------------------------|------|---------|
| 7165 | m | transp. |
| Prodajne dužine (m): 3,0 | | |

Skrivene šarke za RAM 1010



soft close

| art. | j.m. | boja |
|------|------|------|
| 8893 | kom | nikl |



Tehnički detalji profila za izradu fronta

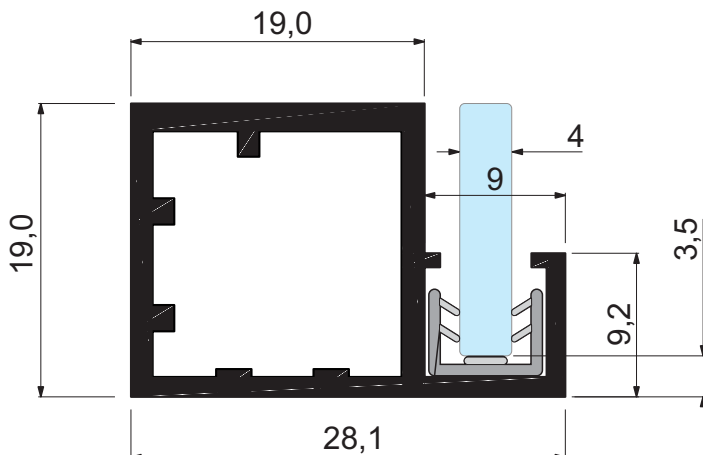

Visina staklene ispune = Visina fronta - 7mm
Širina staklene ispune = Širina fronta - 7mm

RAM 1010 profili za izradu staklenih frontova

Dimenzije i prikaz podešavanja skrivenih šarki

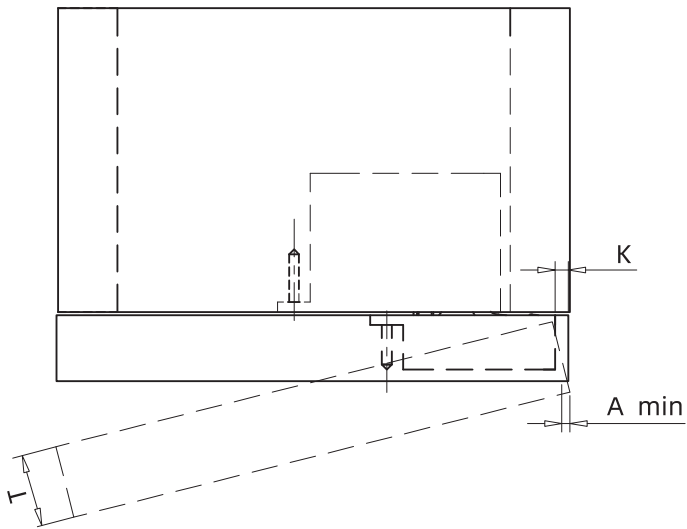

| A \ T \ K | 18 | 20 | 22 | 24 | 26 | 28* | 30 | 32 |
|-----------|----|-----|-----|-----|-----|-----|-----|-----|
| 3* | 0 | 0,2 | 0,5 | 0,8 | 1,4 | 2,5 | 4,2 | 6,0 |
| 4 | 0 | 0,2 | 0,4 | 0,8 | 1,3 | 2,4 | 3,8 | 5,4 |
| 5 | 0 | 0,2 | 0,4 | 0,8 | 1,2 | 2,3 | 3,4 | 5,0 |
| 6 | 0 | 0,2 | 0,4 | 0,8 | 1,2 | 2,2 | 3,2 | 4,5 |

* Konstante koje se odnose na RAM 1010

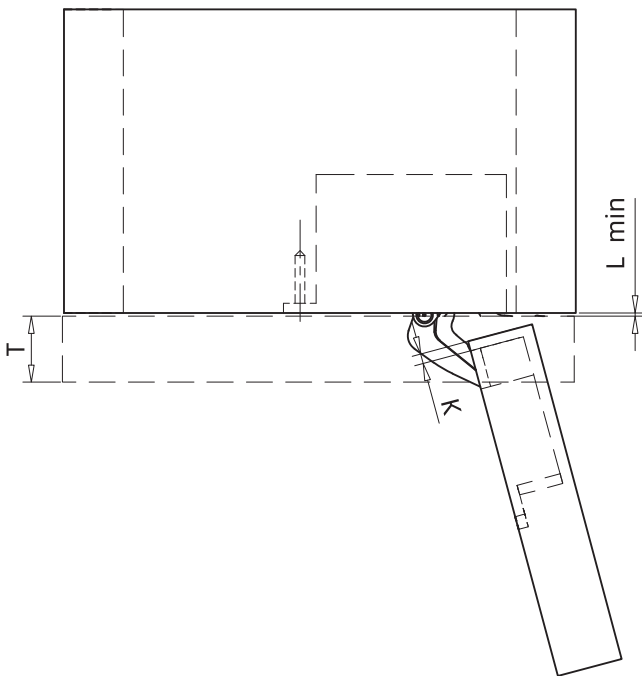

| L \ T \ K | 18 | 20 | 22 | 24 | 26 | 28* | 30 | 32 |
|-----------|-----|-----|-----|-----|-----|-----|-----|-----|
| 3* | 1,0 | 1,0 | 1,0 | 1,0 | 1,0 | 1,0 | 1,0 | 1,0 |
| 4 | 1,0 | 1,0 | 1,0 | 1,0 | 1,0 | 1,0 | 1,0 | 1,0 |
| 5 | 1,0 | 1,0 | 1,0 | 1,0 | 1,0 | 1,0 | 1,0 | 1,0 |
| 6 | 1,0 | 1,0 | 1,0 | 1,0 | 1,0 | 1,0 | 1,0 | 1,0 |

* Konstante koje se odnose na RAM 1010

Lateralno: +2,5 / -0,5

Levo,desno: +2,0 / -2,0

Visinsko podešavanje: +1,0 / -1,0

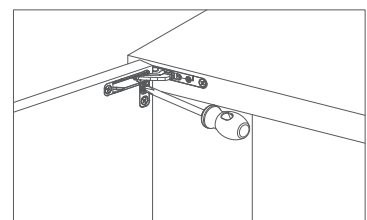
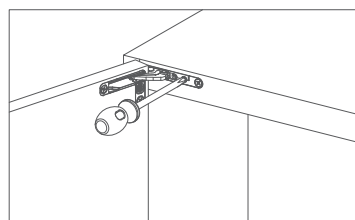
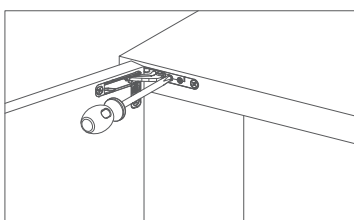
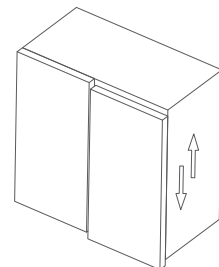
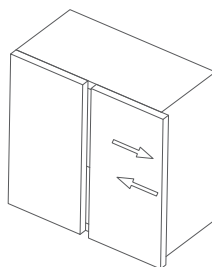
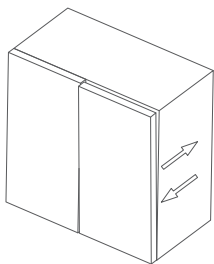

RAM 1010 profili za izradu staklenih frontova

Pozicioniranje otvora za šarke u podu i plafonu korpusa i pozicije rupa za šarku na Al frontu RAM 1010

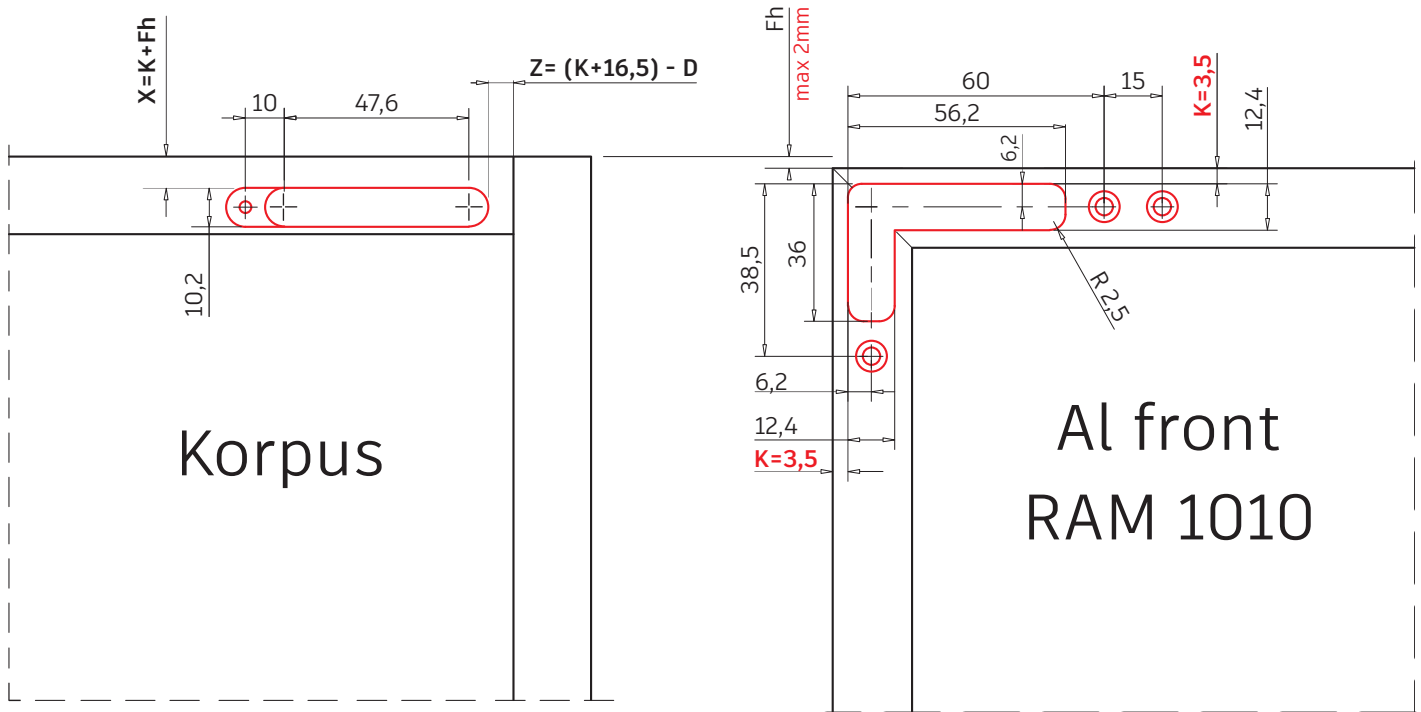

* Rupe su za situacije kada se u pod i plafon korpusa ne postavlja uložak za šarke.

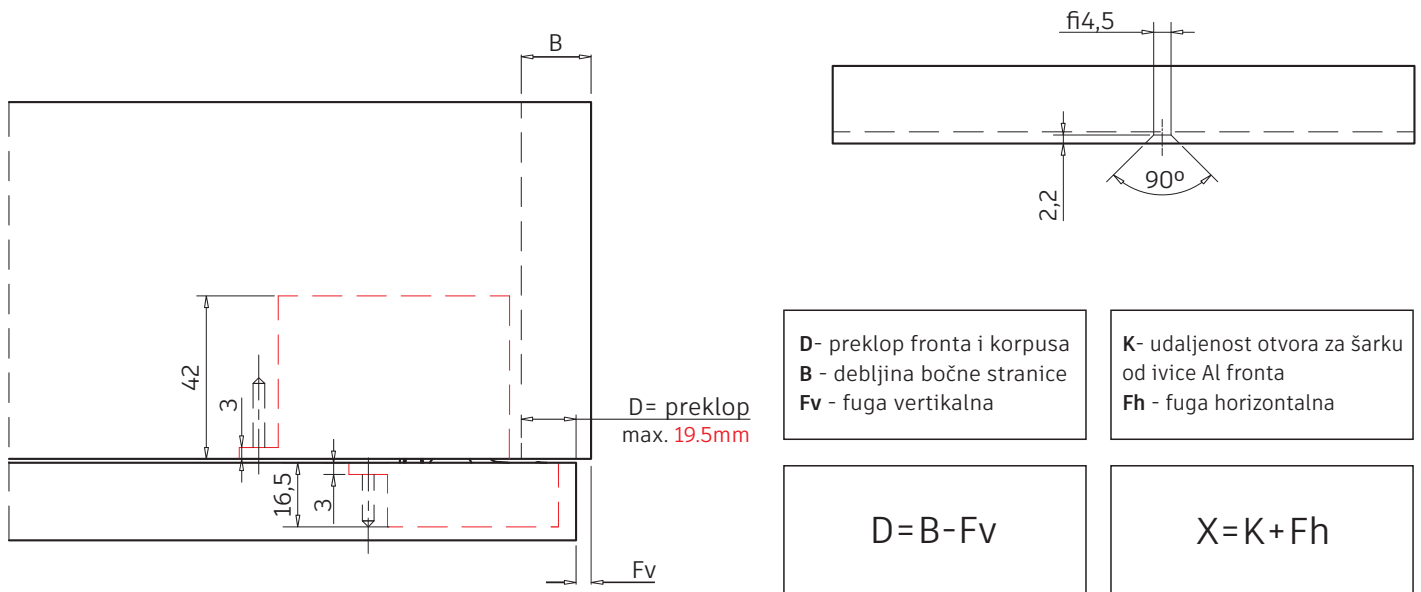

RAM 1010 profili za izradu staklenih frontova

Priprema Al fronta RAM 1010 za sklapanje i montiranje skrivenih šarki

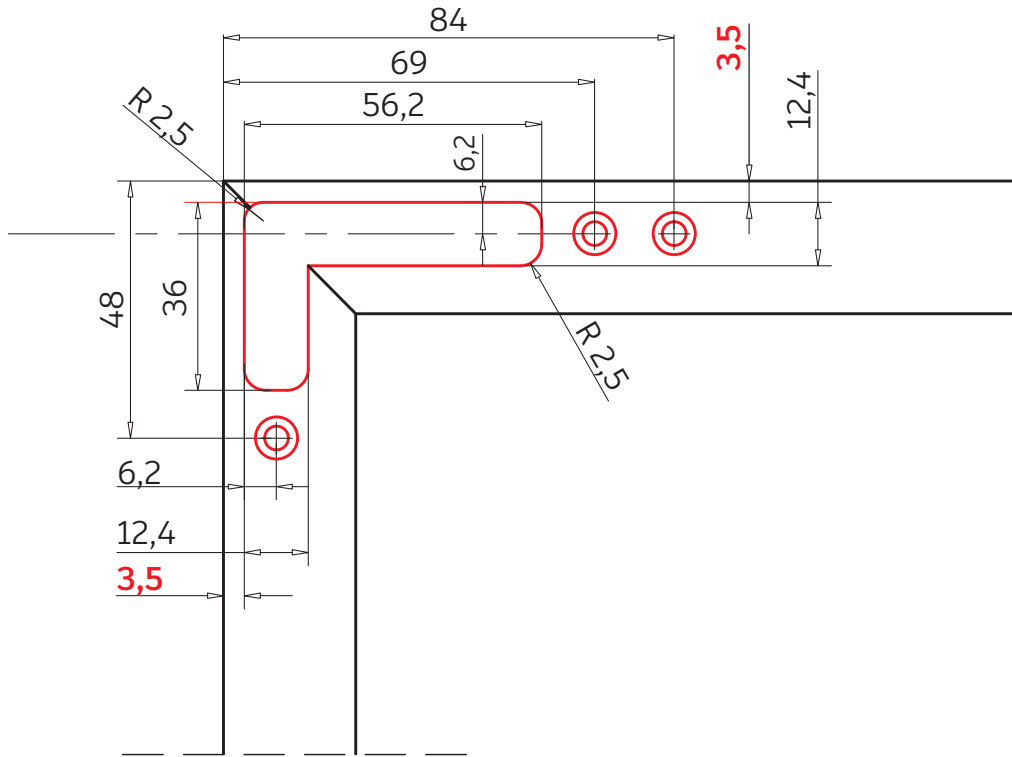

Dimenzije skrivene šarke

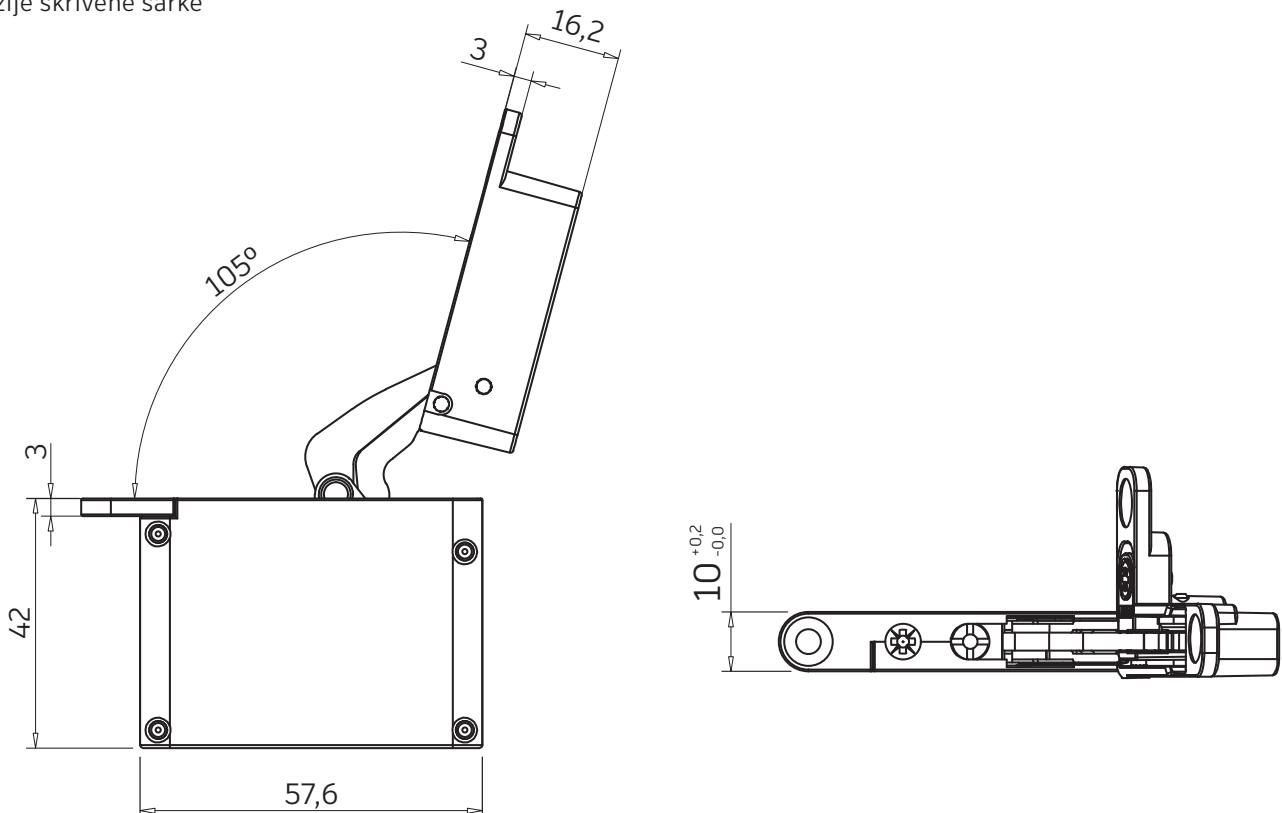

RAM 1010 profili za izradu staklenih frontova

Dekorativne folije za staklene frontove

NOVO!

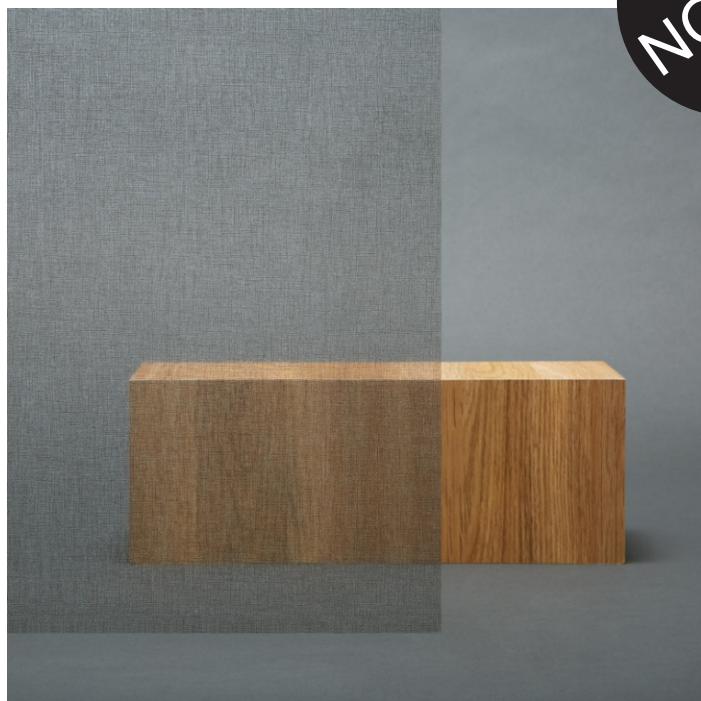

Buckram Pearl + Gray - art. 10188



Seattle - art. 10187

Folije za staklene frontove se koriste u dekorativne svrhe prilikom izrade aluminijumskih ramova sa staklenim ispunama. Širina rolne je 127cm, a dužina rolne je 30m.

Dekorativna folija se prodaje na dužni metar.

Za više detalja možete poslati upit na office@europrofil.rs

